

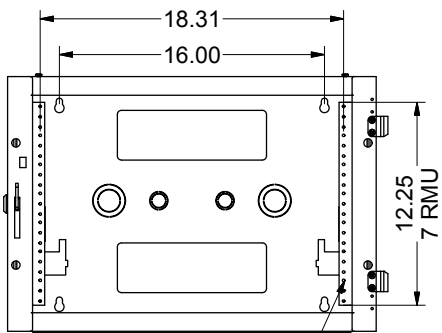

GL15WM

CONSTRUCTION:

- FULLY WELDED MAIN BODY.
- DURABLE TEXTURE POWDER COAT
- #12 GA. C.R.S. EQUIPMENT MTG. RAIL, (1 PAIR)
- #16 GA. C.R.S. REAR WALL PLATE
- # 20 GA. C.R.S. MAIN BODY & DOOR.

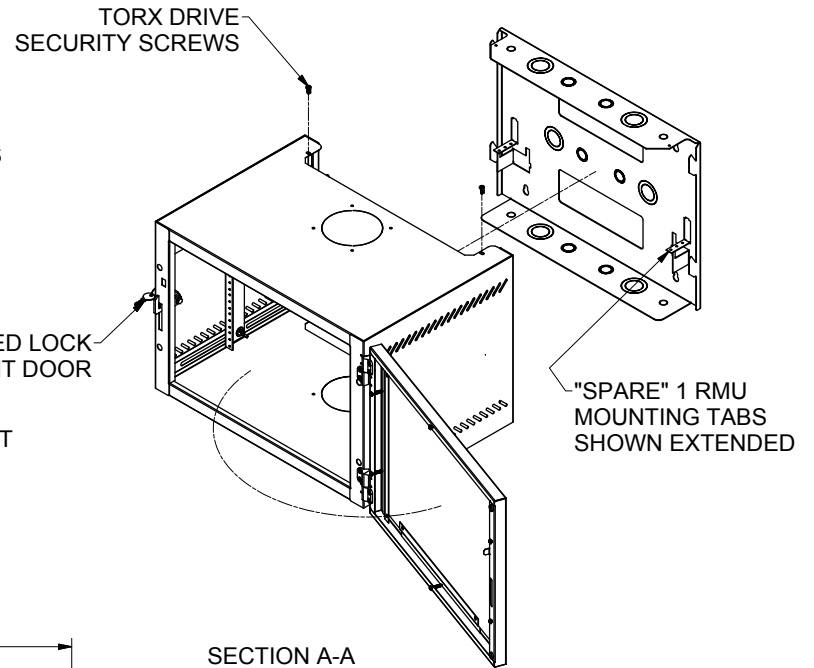
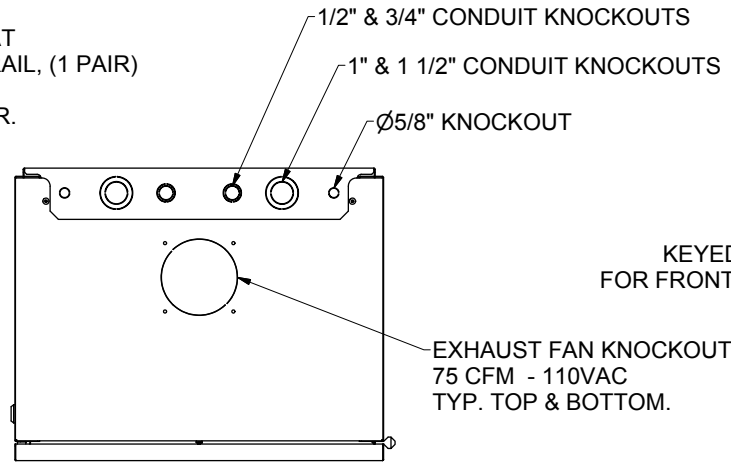

#10-32 TAPPED EIA
MTG. HOLES

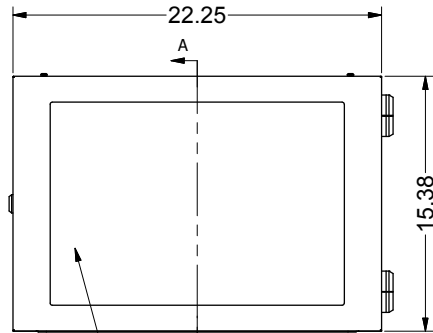

PLEXIGLAS DOOR SHOWN
w/ OPTIONAL SOLID DOOR

